

## Bushing for in-oil application FMB0m-400

Deadbreak operation - Serie 400 rating 400 A

Generally meets the requirements of C 33-001 - C 66-555 - EN 50180

**elascon**  
EC

**formfit**<sup>®</sup>



### Medium Voltage (MV)

Up to 36 kV

MV separable connectors rating 400 A (Interface B)

Reference : FMB0m-400

### Product Application and Design

#### Utilisation

- In-oil insulated equipment (transformers, switchgear...).
- Indoor or outdoor installation.
- Insulation voltage up to 36 kV ( $U_m$ ).
- Continuous 400 A rms (8 hours per 24-hour period).
- Insulation overload 600 A rms (8 hours per 24 hours period)
- Operated when de-energized.
- Interchangeable with 1000 A porcelain bushings.

#### Packing

- Supplied as a kit of 3 pieces.
- Shipping weight and volume (approx) of kit: 12 kg / 0,09 dm<sup>3</sup>.

#### Other products

- Associated products such as separable tee connectors MSCT/EC - 400 , MSCE/EC - 400.



**INTERFACE  
B / 400 A**

### Installation features

- The bushings are fastened to the equipment by means of clamps.
- Vertical or horizontal position.
- 4 attachment tabs for locking brace of separable connector or of dead-end receptacle.
- **May only be energized once the separable connector or the dead-end receptacle installed.**

## Description

- ① **Body**  
Moulded in epoxy resin with electrode insert, suitable for immersion in oil.
- ② **Interface B**  
Part which accepts the mating interface of a connector or of an accessory. The elastic sealing pressure prevents the ingress of moisture.
- ③ **Earthing**  
The electrode insert is connected to earth by a stainless steel plate.
- ④ **Bushing rod**  
Copper rod, with lower part threaded to allow connection to MV windings.
- ⑤ **Socket contact**  
Sliding contact of multipoint type which accepts the pin of the mating item.
- ⑥ **Cap**  
For mechanical protection of the interface during storage and transport. The cap cannot be used for electrical protection.
- ⑦ **Attaching tabs**  
For the locking brace of the separable connector or of the dead-end receptacle.

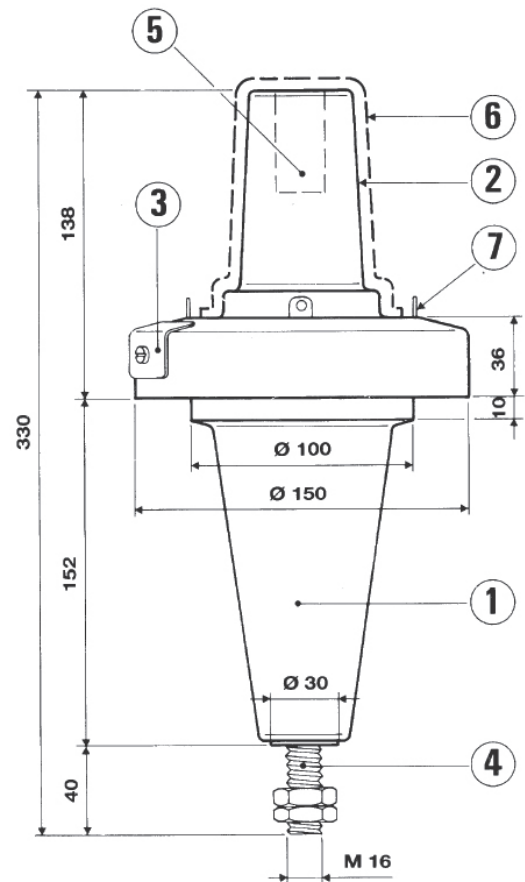

## Selection guide

Select model according to insulation voltage in kV: **12, 24, 36**

Voltage	Reference	H
12 kV	<b>FMBOm-400-12</b>	40 mm
24 kV	<b>FMBOm-400-24</b>	50 mm
36 kV	<b>FMBOm-400-36</b>	70 mm

### Example of order

24 kV, interface B/400 Amp., in-oil application: **FMBOm-400-24**.

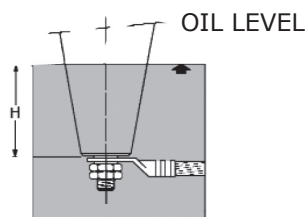

FASTENING SYSTEM  
NF C-52053  
(Clamp)

